

This document must not be copied without our written permission, and the contents thereof must not be imparted to a third party nor be used for any unauthorized purpose. Contravention will be prosecuted.

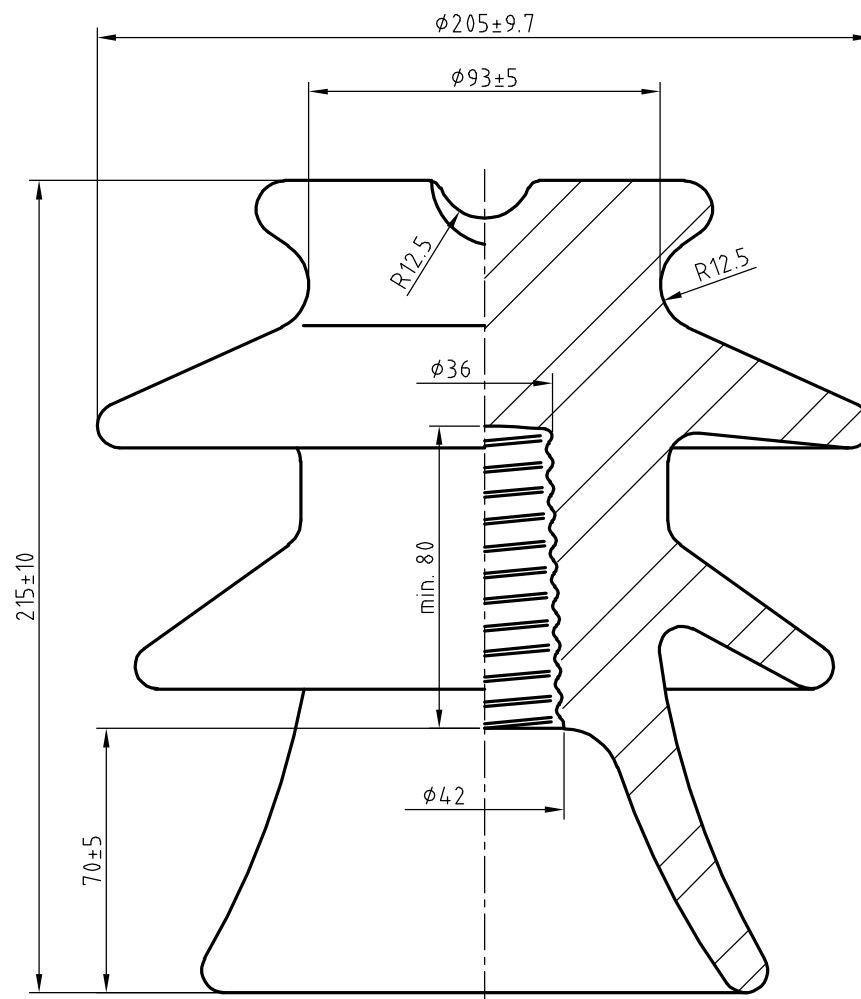

Rated Voltage 24 kV  
Creepage distance: 435 mm  
One minute withstand voltage Wet: 65 kV  
Impulse withstand voltage: 130 kV  
Bending failing load: 12 kN  
Mass: 4.6 kg  
Tested according to IEC 60383 or equivalent.

Scale (%)	Drawn JANEČEK	Checked ĎURÁK	Date 03.03.2022	Ref.
PIN INSULATOR				
VHD-25				
PPC INSULATORS				02
3096-0-P-B				Rev.
Drwg.no.				